

## SPRAY CHARACTERISTICS

- Uniform distribution of droplets in a wide angle solid cone spray pattern.
- Droplet size is larger than in hollow cone nozzles of equal capacity.
- Pressure increases affect spray angles.

## CONSTRUCTION AND MATERIALS

- Hexagonal one piece quick attach body and cross-milled core.
- Core imparts the necessary swirl to produce a solid cone spray pattern.
- Available in Brass and 316 Stainless Steel.

## ORDER EXAMPLE

DFBN 59 Stainless Steel.



### DIMENSIONS (mm)

Nozzle Size	A	B Hex
DFBN STANDARD	21,4	18,0
DFBN LARGE	28,6	25,7

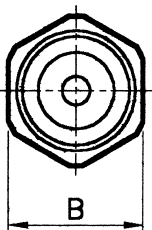

DFBN STANDARD

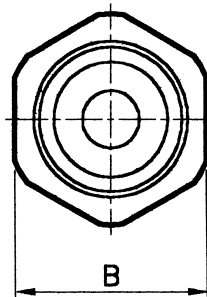
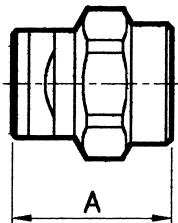

DFBN LARGE

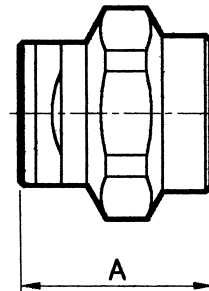

## CAPACITY CHART

NOZZLE NUMBER	BODY SIZE*		FLOW RATE IN LITRES/MIN AT Bar.G.								SPRAY ANGLE (°) @ 2 Bar.G.
	S	L	0,7	1	1,5	2	3	4	6	7	
DFBN 6			1,25	1,50	1,88	2,18	2,65	2,87	3,41	3,54	85
DFBN 8			1,86	2,28	2,84	3,23	4,00	4,55	5,38	5,72	95
DFBN 11			2,79	3,23	3,86	4,31	5,15	5,45	6,73	7,34	120
DFBN 15			3,67	4,50	5,26	5,59	6,64	7,24	8,70	9,16	110
DFBN 18			4,40	5,39	6,30	6,70	7,96	8,68	10,43	10,98	120
DFBN 22			5,58	6,84	8,0	8,50	10,10	11,01	13,23	13,94	110
DFBN 25			6,04	7,24	8,43	9,32	11,01	12,32	14,65	15,76	120
DFBN 32			7,70	9,15	10,80	11,92	14,30	15,78	18,90	19,90	110
DFBN 39			9,40	11,15	13,14	14,52	17,40	19,20	23,00	24,25	120
DFBN 46			11,62	13,64	15,86	17,27	19,29	22,32	25,45	27,88	112
DFBN 48			12,52	15,25	16,87	18,18	23,13	24,54	29,80	32,52	120
DFBN 59			13,23	15,96	19,29	22,32	26,06	28,18	34,64	37,67	128

\* S = for use with 1/4" or 3/8" Dela-Fit Bodies. L = for use with 1/2" Dela-Fit Bodies.

DELA-FIT

TYPE DFBN

Contact our Helpline for any special requirements:  
Tel: +44 (0) 151 424 6821  
Fax: +44 (0) 151 495 1043  
e-mail: sales@delavan.co.uk  
Web: www.delavan.co.uk

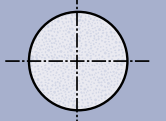
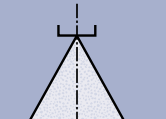

DF