



SPRAY CHARACTERISTICS

- Uniform distribution of droplets in a solid cone spray pattern.
- Droplet size is larger than in hollow cone nozzles of equal capacity.
- Impact is generally greater with narrower spray angles, assuming the same flow rate. Pressure increases affect spray angles.

CONSTRUCTION AND MATERIALS

- Hexagonal one piece quick attach body and cross-milled core.
- Core imparts the necessary swirl to produce a solid cone spray pattern.
- Available in Brass and 316 Stainless Steel.

ORDER EXAMPLE

DFBI 49 Stainless Steel.

DIMENSIONS (mm)

Nozzle Size	A	B Hex
DFBI STANDARD	21,4	18,0
DFBI LARGE	28,6	25,7

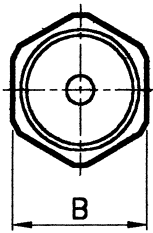

DFBI STANDARD

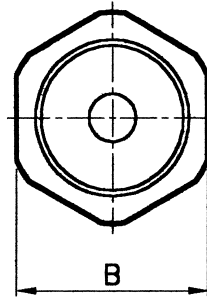
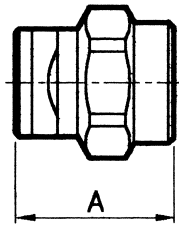

DFBI LARGE

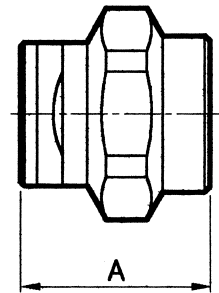

CAPACITY CHART

NOZZLE NUMBER	BODY SIZE*		FLOW RATES IN LITRES/MIN AT Bar.G.								SPRAY ANGLE (°) @ 2 Bar.G.
	S	L	0,7	1	1.5	2	3	4	6	7	
DFBI 6			1,25	1,50	1,88	2,18	2,65	2,87	3,41	3,54	47
DFBI 8			1,86	2,28	2,84	3,23	4,00	4,55	5,38	5,72	56
DFBI 11			2,32	2,87	3,62	4,05	4,87	5,36	6,30	6,74	64
DFBI 12			2,79	3,41	4,09	4,55	5,30	5,91	7,02	7,58	70
DFBI 16			3,58	4,41	5,30	6,14	7,27	8,00	9,51	10,04	60
DFBI 20			4,46	5,46	6,50	7,54	9,06	10,00	11,92	12,63	73
DFBI 22			5,11	6,24	7,51	8,32	9,78	10,91	13,23	14,24	80
DFBI 27			6,04	7,42	9,01	10,10	12,32	13,64	16,06	17,47	53
DFBI 32			7,25	8,88	10,81	12,32	14,44	15,96	19,29	20,40	70
DFBI 42			9,67	11,82	14,44	15,96	19,29	21,41	24,95	27,37	76
DFBI 47			10,61	13,03	14,95	17,78	21,11	23,63	28,38	30,20	57
DFBI 49			11,62	14,24	16,36	18,69	23,13	25,05	29,29	32,52	86
DFBI 63			14,44	17,07	20,50	23,84	28,89	32,22	38,48	41,31	69

*S = for use with 1/4" or 3/8" Dela-Fit Bodies. L = for use with 1/2" Dela-Fit Bodies.

Contact our Helpline for any special requirements:
Tel: +44 (0) 151 424 6821
Fax: +44 (0) 151 495 1043
e-mail: sales@delavan.co.uk
Web: www.delavan.co.uk

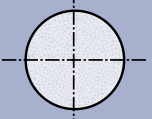
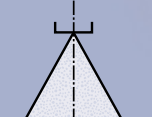

DF